

# Ultra-Matic® 2" Food Processing Pump

# U2

## Specifications

	English	Metric
<b>Flow rate</b>		
adjustable to	0-182 gpm	0-689 lpm
<b>Port size</b>		
Inlet and Outlet	2.5" Tri-Clamp	
<b>Air inlet</b>	0.50" Female NPT	
<b>Air exhaust</b>	0.75" Female NPT	
<b>Suction lift* (dry)</b>		
Rubber	20'	6.10
Teflon®	10'	3.05 m
<b>Max. particle size</b>		
Diameter	0.44"	11 mm
<b>Shipping weight</b>		
Stainless Steel	117 lbs	53 kg

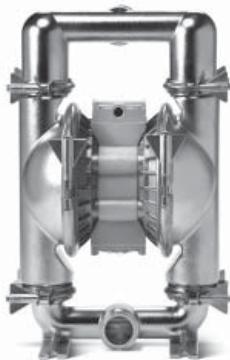

## Performance

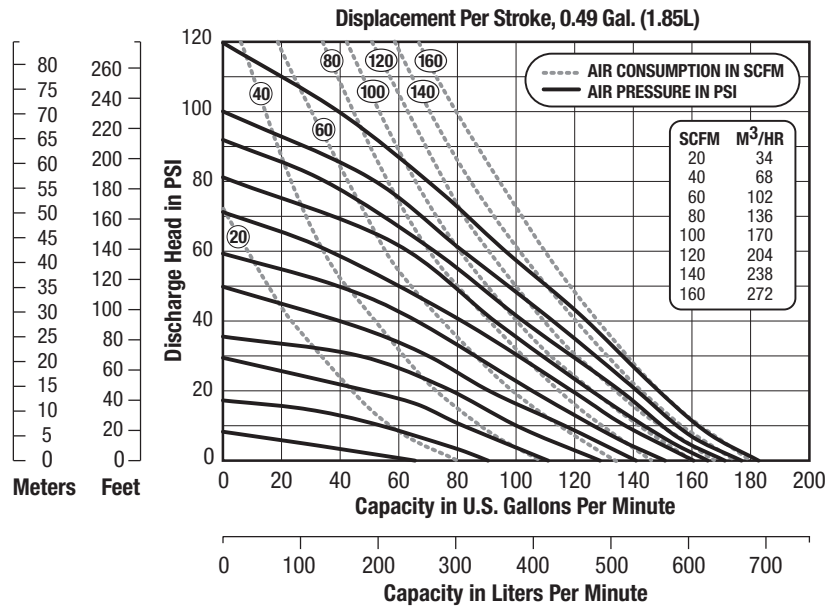

**NOTE:** For U2 pumps fitted with PTFE diaphragms, reduce water discharge figures by 20%. Suction lift is reduced to 10' (3.05m) dry and 20' (6.10m) wet.

**CAUTION:** Do not exceed 125 psig (8.5 bars) air supply or liquid pressure.

## Dimensions

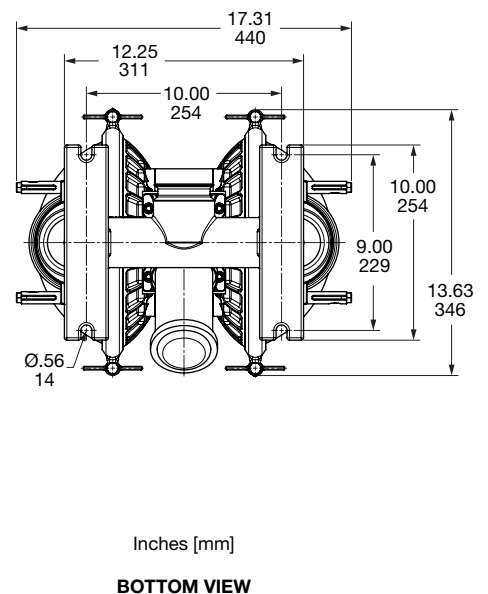
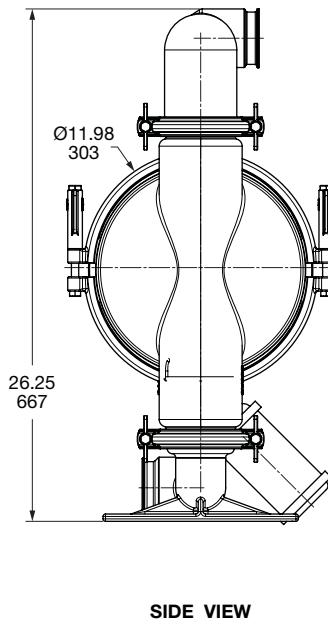
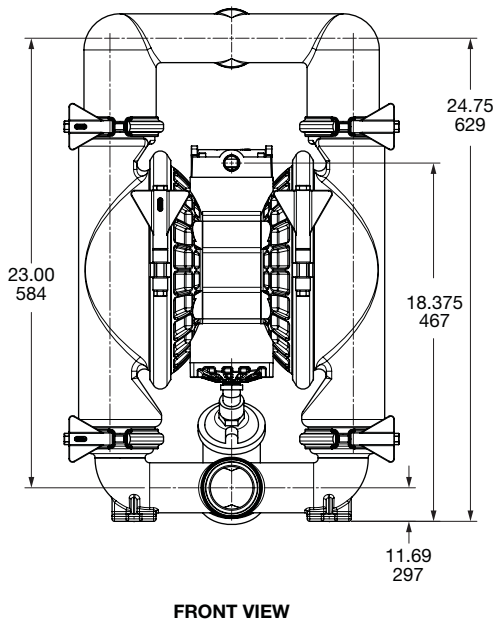

Consult factory for certified drawings.